

Model / ABOC

Cutter type Submersible Pump

Application

- ◆ Drainage of waste water containing fibrous additives from leather factory, dyeing factory and food processing factory.
- ◆ Swage management, accumulated water, septic tank, stock farm.
- ◆ Drainage of waste water from the attenuation tank, purifying tank and sewage tank in water treatment plant.



Features

- ◆ The cutter pumps, with a tungsten carbide edged impeller, are perfect for pumping sewage and breaking/tearing solids in sewage treatment plants.
- ◆ Semi-open impeller and cutter casing cover shreds against the inner cutting blades to break down destructible solids into small pieces to prevent clogging in the pump. The heat hardened casing cover is designed to withstand abrasions.

Identification code

80 ABOC - 5 1.5 S - C
 ① ② ③ ④ ⑤ ⑥

- ① Bore size (mm) ② Pump model
- ③ Hz ④ Motor output (kW)
- ⑤ S : Single phase ⑥ C / Quick discharge connector

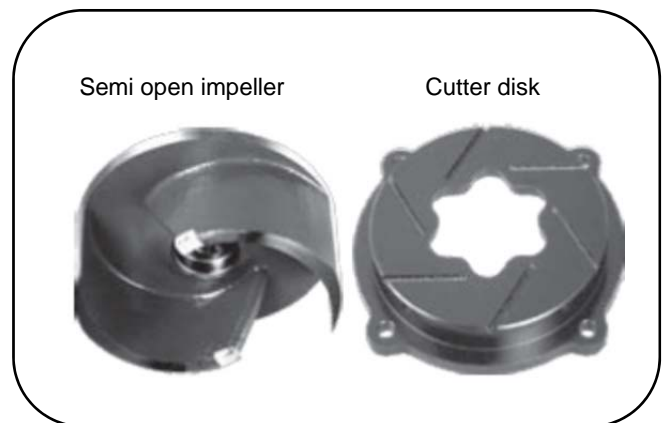

Standard Specifications

Liquid	Kind	Waste water
	Temp.	0~40 degree C
Max. depth	30m	
Structure	Impeller	Semi open
	Cutting device	Cutter disk
	Shaft seal	Double mechanical seal
	Bearing	Sealed ball bearing
Material	Impeller	FC200(Cast iron) + Tungsten
	Casing	FC200(Cast iron)
	Casing cover	FC200(Cast iron) + Heat treatment
	Upper cover	FC200(Cast iron)
	Shaft	SUS403(Stainless) (~7.5kW) SUS420J2 (Stainless) (11kW)
	Mech. Seal	CA / CE & Sic / Sic
Motor	Type	Dry - IP68
	Insulation	B class (0.4~2.2kW) F class (3.7kW) H class (5.5~11kW)
	Protector	Auto-cut
	Cable	VCT

Performance Specification

Model	Bore	Output	Phase	Capacity m ³ /min	Head m
80ABOC-51.5S	80	1.5	1	0.4	10.7
80ABOC-51.5	80	1.5	3	0.4	10.7
80ABOC-52.2S	80	2.2	1	0.4	13.8
80ABOC-52.2	80	2.2	3	0.4	13.8
80ABOC-53.7	80	3.7	3	0.4	21.8
80ABOC-55.5	80	5.5	3	0.6	26
80ABOC-57.5	80	7.5	3	0.6	33
80ABOC-511	80	11	3	0.6	44
100ABOC-55.5	100	5.5	3	1.0	19.5
100ABOC-57.5	100	7.5	3	1.0	26
100ABOC-511	100	11	3	1.0	37

Model / ABOC

Cutter type Submersible Pump

Selection chart

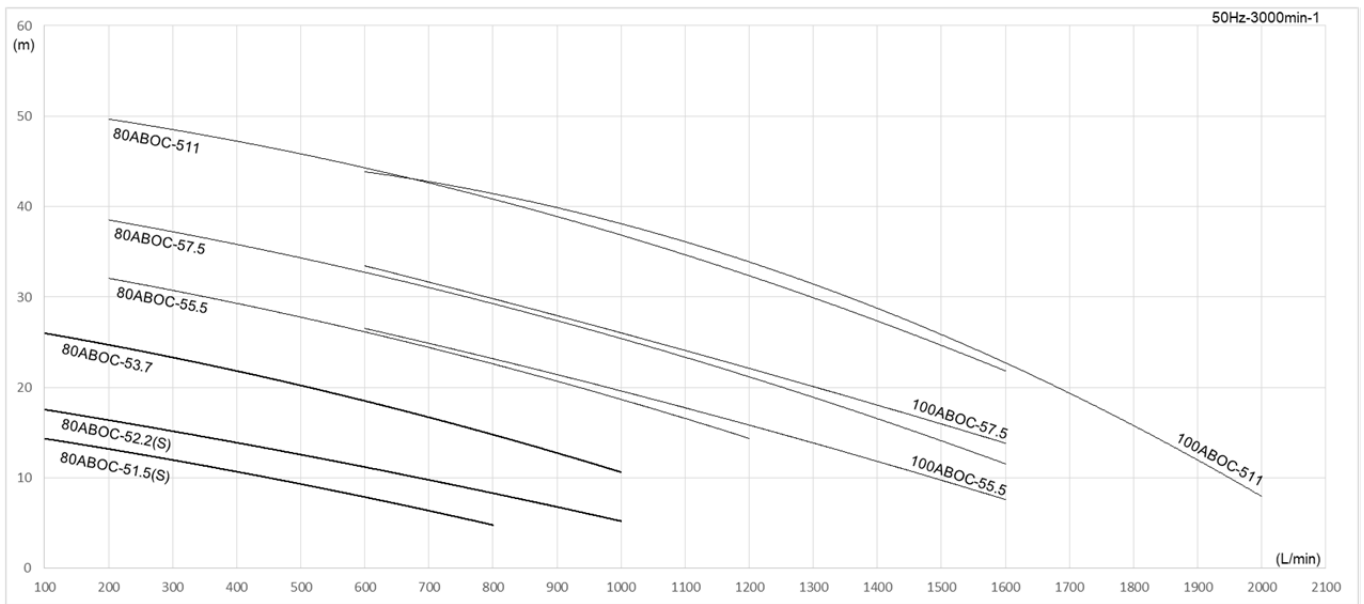

Dimensions

Fig.1

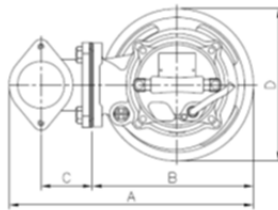
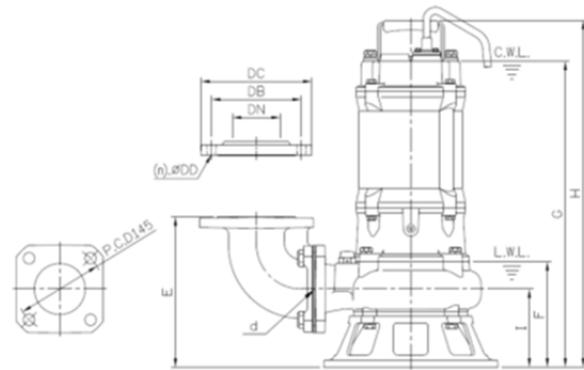
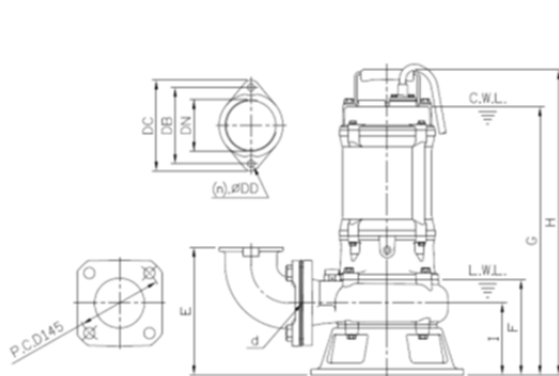
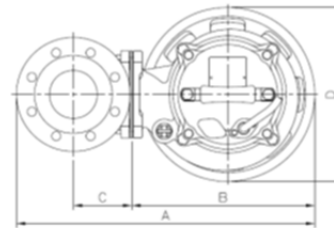

Fig.2



(Unit / mm)

Model	Fig.	DN	A	B	C	D	E	F	G	H	I	DB	DC	DD-n	Weight (kg)	Cable
80ABOC-51.5S	1	80	417	275	88	260	218	163	513	576	123	130	155	12-2	42	8000
80ABOC-51.5	1	80	417	275	88	260	218	163	458	521	123	130	155	12-2	38	8000
80ABOC-52.2S	1	80	417	275	88	260	218	163	540	603	123	130	155	12-2	45	8000
80ABOC-52.2	1	80	417	275	88	260	218	163	458	521	123	130	155	12-2	40	8000
80ABOC-53.7	2	80	498	305	98	290	250	176	510	578	130	150	185	15-8	60	8000
80ABOC-55.5	2	80	565	373	98	345	271	198	590	689	151	150	185	15-8	87	10000
80ABOC-57.5	2	80	565	373	98	345	271	198	590	689	151	150	185	15-8	93	10000
80ABOC-511	2	80	565	373	98	345	271	198	630	729	151	150	185	15-8	103	10000
100ABOC-55.5	2	100	596	373	113	345	282	198	590	689	151	175	210	15-8	89	10000
100ABOC-57.5	2	100	596	373	113	345	282	198	590	689	151	175	210	15-8	95	10000
100ABOC-511	2	100	596	373	113	345	282	198	630	729	151	175	210	15-8	105	10000